

NETZSCH NBE 200 Drum Emptying Unit

Empties >99% of drum contents with viscosities up to 5 M cps

NETZSCH Drum Emptying Units actually pump their way through your products reaching the bottom of the drum with less than 1% of product left in the container. The heart of the drum emptying unit is a NEMO® progressing cavity pump which creates positive displacement, low pulsation flow to convey your product without damage. In fact, most products are only exposed to the friction loss through the discharge piping. The NETZSCH single slide rail system raises and lowers the follower plate safely while providing a simple and easy structure to clean.

*Sanitary Prime PC Pump offers FDA compliant budget level solutions
Sanitary Advanced PC Pump offers hygienic design and CIPability.*

NETZSCH NBE 200 Features:

- Continuous or intermittent emptying
- No pressure or flow interruption
- Emptying of conical drums as an option
- Low Pressure conditions in the entire system
- Option to meter direct from the drum
- Flow is in direct proportion to pump speed
- VFD provides adjustable discharge flow rates
- Simple, single-rail design
- Drum clamp to secure the drum in place

Your Benefits:

- Very smooth conveyance
- Low pulsation
- Low shear PC pump to convey product
- Conveys products with solids without degradation
- Flow is independent of temperature or viscosity
- 99 %+ of product evacuated from drum
- Low life cycle costs
- Stainless steel, easy-to-clean design
- Auto shut-off of pump when drum is empty

Applications

- Designed for non-flowable products but can pump low viscosity products as well
- Non-Newtonian or thixotropic fluids and pastes
- Shear and pressure sensitive products
- Highly abrasive materials
- Pump can handle products up to 5 million cps



NETZSCH NBE 200 Drum Emptying Unit

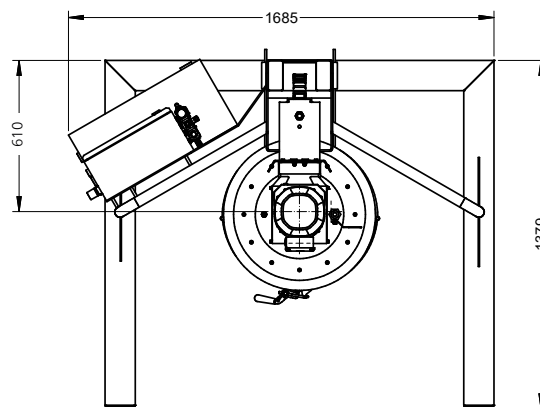
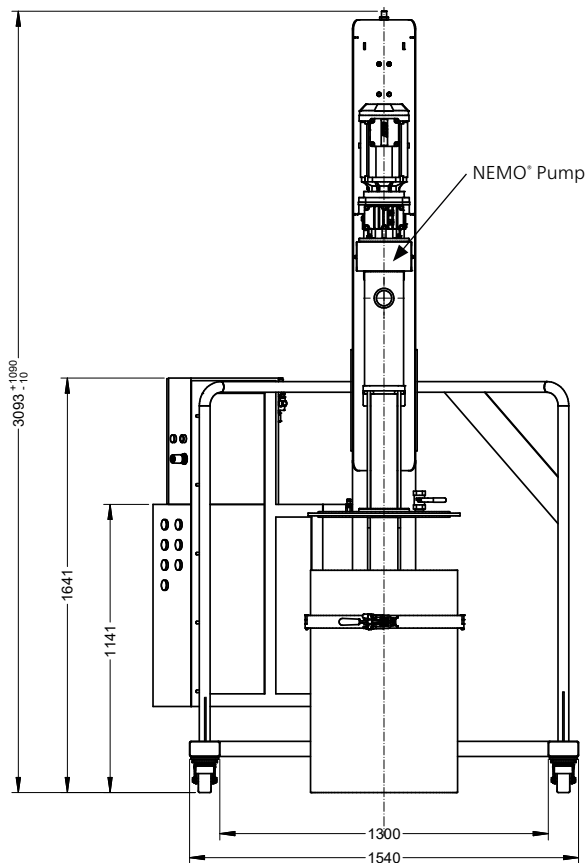

*all dimensions in mm

Characteristics:

Base frame: Stainless steel
Frame options: With or without casters
Wetted Parts: 1.4571 / stainless steel 316
Drum sizes: 55 gal. / 200 liter standard, others on request
Wiping ring: NBR, EPDM, Viton, (Food Grade FDA compliant)
Flow rate: Up to 44 gpm / 10 m³/h*

Pump: BY industrial pump, BH sanitary pump, sizes up to NM063
Back pressure: Up to 290 psi / 20 bar* Max., higher pressure on request
Control: Standard with VFD control panel (NEMA / IP 65)
Optional: PLC metering control unit

*depending on product

NETZSCH Pumps USA
 119 Pickering Way, Exton, PA 19341
 Tel: 610 363-8010 ■ Fax: 610 363-0971
 npa@netzsch.com

NETZSCH Canada, Incorporated
 500 Welham Road, Barrie, ON L4N 8Z7
 Tel: 705 797-8426 ■ Fax: 705 797-8427
 ntc@netzsch.com

NETZSCH Pumps USA
 1511 FM 1960 Road, Houston, TX 77073
 Tel.: 346 445-2400
 npa@netzsch.com

NETZSCH Canada, Incorporated
 5050 76th Ave SE, Calgary, AB T2C 2X2
 Tel.: 866 683-7867
 ntc@netzsch.com

NETZSCH

Proven Excellence.

pumps-systems.netzsch.com